

Earthing devices / Equipment accessories

30911 Low voltage clamps

MPUE

Code 671112

Dimensions: 335 x 81 x 52 mm
Weight: 0.6 kg

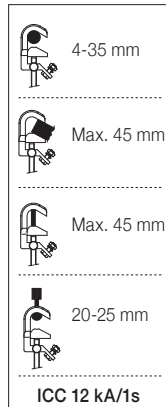

MPUL

Code 671113

Dimensions: 335 x 81 x 52 mm
Weight: 1.2 kg

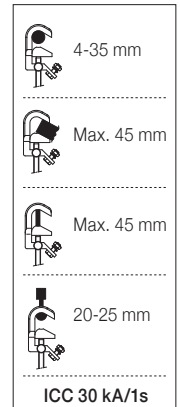

PEBT

Code 658115

Dimensions: 815 x 58 x 40 mm
Weight: 0.35 kg

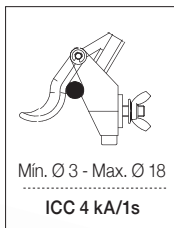

Min. Ø 3 - Max. Ø 18
ICC 4 kA/1s

MPUBT

Code 659001P

Dimensions: 160 x 82 x 40 mm
Weight: 0.36 kg

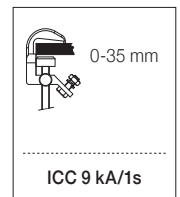

Earthing devices / Equipment accessories

30911 Medium voltage clamps

MPUH

Code 671110

Dimensions: 202 x 81 x 40 mm
Weight: 0.48 kg



MPUH-L

Code 671117

Dimensions: 202 x 81 x 40 mm
Weight: 1.16 kg



MPUB

Code 671115

Dimensions: 240 x 81 x 40 mm
Weight: 0.53 kg

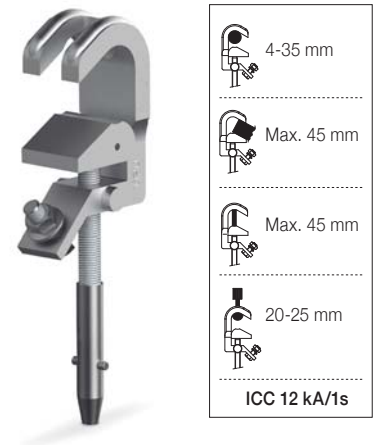

MPUB-L

Code 671118

Dimensions: 240 x 81 x 40 mm
Weight: 1.65 kg

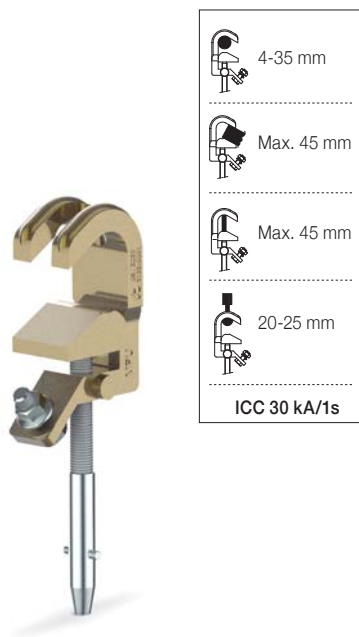

PC

Code 666005

Dimensions: 440 x 157 x 54 mm
Weight: 1.3 kg



MPUP

Code 671116

Dimensions: 240 x 81 x 156 mm
Weight: 0.7 kg



Earthing devices / Equipment accessories

30911 Medium voltage clamps

MPUP-L

Code 671119

Dimensions: 240 x 81 x 156 mm
Weight: 1.34 kg

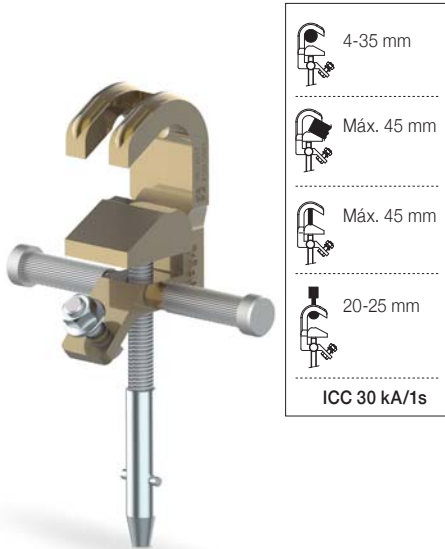

PDC

Code 666010

Dimensions: 413 x 105 x 52 mm
Weight: 0.85 kg

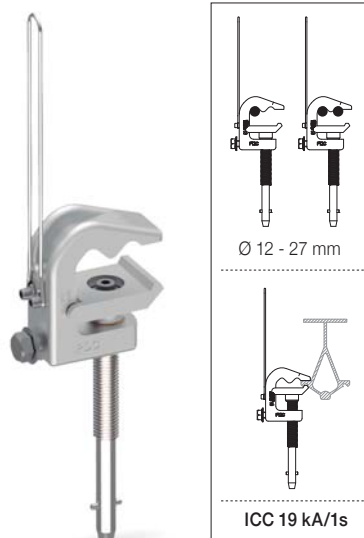

MCL

Code 671121

Dimensions: 182 x 128 x 68 mm
Weight: 0.67 kg



5014H

Code 671100

Dimensions: 167 x 91 x 83 mm
Weight: 0.8 kg

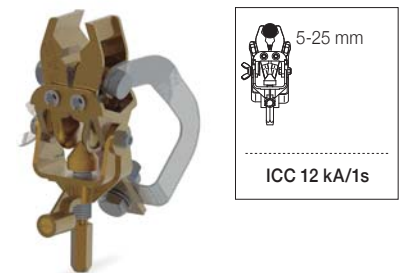

MC

Code 671120

Dimensions: 226 x 102 x 62 mm
Weight: 0.4 kg



PCA-25

Code 671171

Dimensions: 276 x 123 x 74 mm
Weight: 0.81 kg



PP15

Code 671166

Dimensions: 241 x 95 x 47 mm
Weight: 0.68 kg



Earthing devices / Equipment accessories

30911 High voltage clamps

MPL

Code 671172

Dimensions: 263 x 105 x 62 mm
Weight: 0.97 kg

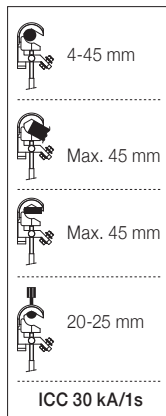

MPLE

Code 671178

Dimensions: 263 x 110 x 62 mm
Weight: 1 kg

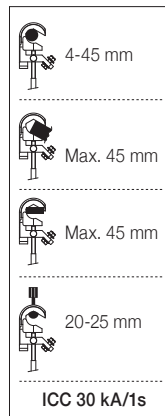

MPLP

Code 671173

Dimensions: 263 x 105 x 204 mm
Weight: 1.1 kg

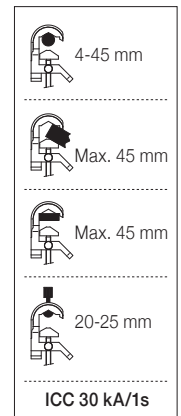

PAV-48

Code 673100

Dimensions: 380 x 170 x 120 mm
Weight: 1.6 kg

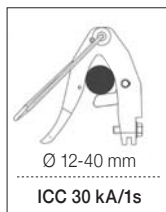

TML

Code 670100P

Dimensions: 428 x 133 x 53 mm
Weight: 1.56 kg

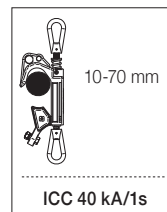

TMC

Code 675100P

Dimensions: 273 x 248 x 45 mm
Weight: 1.18 kg

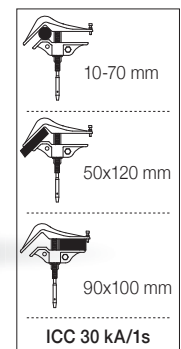

Earthing devices / Equipment accessories

30911 High voltage clamps

PA40A

Code 674100 - Bayonet
Code 674102 - Hexagonal

Dimensions: 331 x 206 x 80 mm
Weight: 1.7 kg

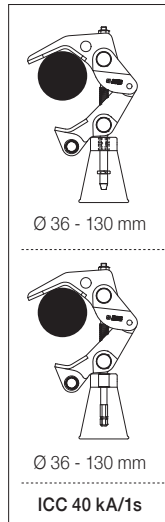

PA40ABP

Code 674105 - Hexagonal H22

Dimensions: 341 x 206 x 80 mm
Weight: 1.6 kg

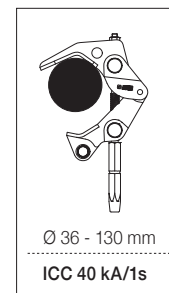

30911 Low voltage handles

EMB

Code 671106

Dimensions: 198 x Ø 52 mm
Weight: 0.3 kg



EMP

Code 659001E

Dimensions: 218 x Ø 52 mm
Weight: 0.25 kg



30911 Potential drop clamp

BPGA

Code 672205

Dimensions: 3262 x 141 x 298 mm
Weight: 7.8 kg

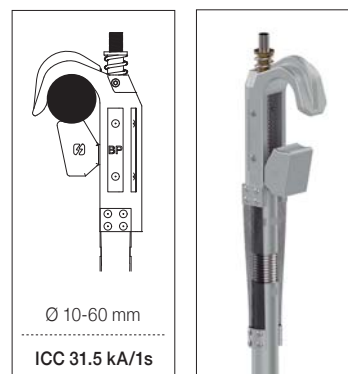

Earthing devices / Equipment accessories

30911 Earthing lathe

TT-38A

Code 671141

Dimensions: 158 x 92 x 35 mm
Weight: 0.48 kg

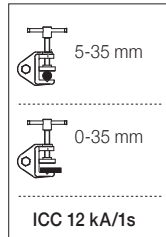

TT-38L

Code 671145

Dimensions: 158 x 92 x 35 mm
Weight: 0.93 kg

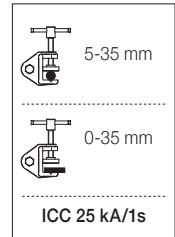

TT-50

Code 671152

Dimensions: 250 x 147 x 40 mm
Weight: 0.95 kg

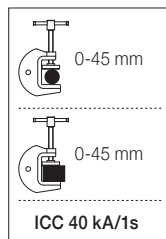

TTSR

Code 666015

Dimensions: 280 x 214 x 55 mm
Weight: 3.45 kg

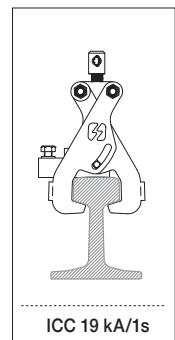

TTR

Code 671153

Dimensions: 115 x 117 x 60 mm
Weight: 1.1 kg

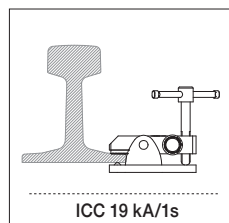

TTIR

Code 671154

Dimensions: 54 x 65 x 50 mm
Weight: 0.95 kg

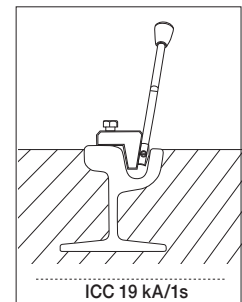

Earthing devices / Equipment accessories

30911 Vandal-proof earthing lathe

TTR-AN

Code 30911000

Dimensions: 115 x 117 x 60 mm
Weight: 1.1 kg

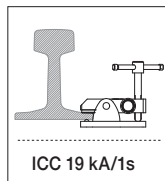

The TTR-AN vandal-proof earthing lathe is specially designed for portable earthing equipment, providing secure fastening in areas exposed to the public or where there is a risk of unauthorized handling.

Its design includes a removable pin, which the operator inserts during installation and then removes and stores. Once the pin is removed, the turnstile cannot be opened or disassembled, preventing third parties from tampering with the earthing connection.

Manufactured with high-strength materials and a robust clamping system, the TTR-AN ensures reliable, safe, and long-lasting use in maintenance, repair, and operational tasks.

30911 Earthing lathe

PEP

EQUIPOTENTIAL CLAMP FOR POST

Code P-671180

Dimensions: 420 x 202 x 70 mm
Weight: 4.5 kg



Max. Ø 400 mm



Min. Ø 90 mm



PEP-ECO

EQUIPOTENTIAL CLAMP FOR POST

Code P-671185

Dimensions: 325 x 200 x 60 mm
Weight: 3.7 kg



Max. Ø 400 mm



Min. Ø 90 mm



Earthing devices / Equipment accessories

30911 Articulated dispenser heads

The PPA clamp holder plates have been designed to enhance ergonomics and speed during the installation of earthing equipment. Unlike standard models, these plates feature articulated dispenser heads that allow each clamp to be positioned individually, better conforming to the geometry

of the support or connection point. This articulation ensures more comfortable, faster, and precise positioning, reducing the operator's handling time and facilitating assembly even in complex configurations or confined spaces.

PPA-3

Code 30911005



PPA-4

Code 30911006



PPA-3U

Code 30911007



PPA-4U

Code 30911008



30911 Dispenser heads

PP-3

Code 671126



PP-4

Code 671127



PP-3U

Code 671128



PP-4U

Code 671129



PP-3 MCL

Code 671131



PP-4 MCL

Code 671132



PP-3U MCL

Code 671122



PP-4U MCL

Code 671123



PP-1U MCL

Code 630168



Earthing devices / Equipment accessories

30911 Wheeled suitcase

SOFABOX

Code 620061

Dimensions: 855 x 577 x 400 mm

Ideal for transporting earthing and short-circuiting devices. It ensures easy and convenient mobility, offering a reliable solution for safely moving equipment to different job sites.



Foldable steel leg
Allowing horizontal storage of the case.



Foldable handles
The suitcase has handles on the top, bottom, and side to allow easy transport at all times.



30911 Earthing rod

Hexagonal earthing rod

Code 667150

Dimensions: 1 m
Weight: 2.150 kg

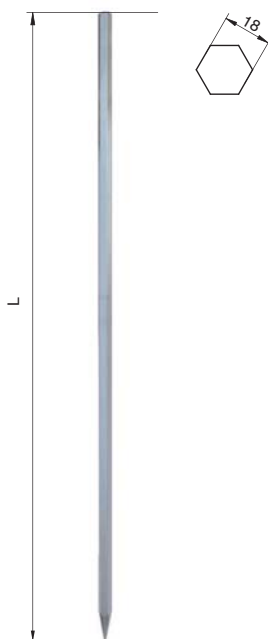

Helical earthing rod

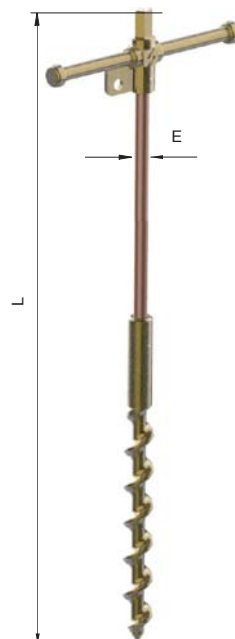

Code	Ref.	L	ØE	kg
P-671190	PTB14-1000	1000		2.7
P-671191	PTB14-1300	1300	14.6	2.85
P-671192	PTB14-1500	1500		3
P-671193	PTB18-1000	1000		3.2
P-671194	PTB18-1300	1300	18.2	3.55
P-671195	PTB18-1500	1500		3.86

Earthing devices / Equipment accessories

Fixed ball point

Used in electrical installations to connect and securely fasten the clamps of PAT equipment.

According to DIN 48088 part 1. - Material: 20 micron tinned brass and stainless hardware.

30912 Straigh fixed ball point - Female

INTERNAL THREAD

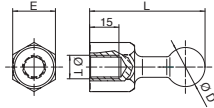

Code	Ref.	ØD	ICC Max. kA/1s	E	L	ØT
P-665020	PFRH-20M12	20	12	SW22	59	M12
P-665022	PFRH-20M16					M16
P-665024	PFRH-20M12	25	25	SW27	69	M12
P-665026	PFRH-20M16					M16

30913 Straigh fixed ball point - Male

EXTERNAL THREAD

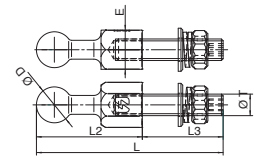

Code	Ref.	ØD	ICC Max. kA/1s	E	L	L2	L3	ØT
P-665030	PFRM-20M12x35	20	12	SW22	94	59	35	M12
P-665032	PFRM-20M12x45						45	M12
P-665034	PFRM-20M16x35						35	M16
P-665036	PFRM-20M16x45						45	M16
P-665038	PFRM-25M12x35	25	25	SW27	104	69	35	M12
P-665040	PFRM-25M12x45						45	M12
P-665042	PFRM-25M16x35						35	M16
P-665044	PFRM-25M16x45						45	M16

30912 Fix ball point 45° - Female

INTERNAL THREAD

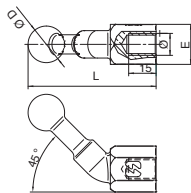

Code	Ref.	ØD	ICC Max. kA/1s	E	L	ØT
P-665050	PF45H-20M12	20	12	SW22	70	M12
P-665052	PF45H-20M16					M16
P-665054	PF45H-25M12	25	25	SW27	82	M12
P-665056	PF45H-25M16					M16

30913 Fix ball point 45° - Male

EXTERNAL THREAD

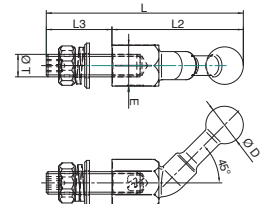

Code	Ref.	ØD	ICC Max. kA/1s	E	L	L2	L3	ØT
P-665060	PF45M-20M12x35	20	12	SW22	105	70	35	M12
P-665062	PF45M-20M16x45						45	M16
P-665064	PF45M-25M12x45	25	25	SW27	127	82	45	M12
P-665066	PF45M-25M16x45						45	M16

30912 Fix ball point 90° - Female

INTERNAL THREAD

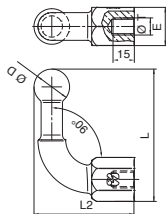

Code	Ref.	ØD	ICC Max. kA/1s	E	L	L2	ØT
P-665070	PF90H-20M12	20	12	SW22	75	58	M12
P-665072	PF90H-20M16						M16
P-665074	PF90H-25M12	25	25	SW27	93	70	M12
P-665076	PF90H-25M16						M16

30913 Fix ball point 90° - Male

EXTERNAL THREAD

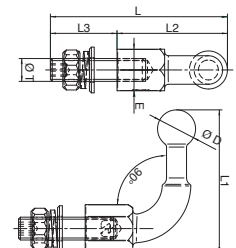

Code	Ref.	ØD	ICC Max. kA/1s	E	L	L2	L3	ØT
P-665080	PF90M-20M12x35	20	12	SW22	93	58	35	M12
P-665082	PF90M-20M16x45						45	M16
P-665084	PF90M-25M12x45	25	25	SW27	115	70	45	M12
P-665086	PF90M-25M16x45						45	M16