

Battery Terminals

Connection

CONNECTION CATALOGUE

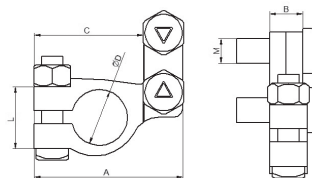

11404 SCF/BB

Battery terminals

Set of 2 brass terminals for connecting the cable to the battery: includes one positive and one negative terminal. Possibility of using cable from other sections, with lugs.



Code	Ref.	Cable Section		Dimensions (mm)							Kg x 100 (The pair)	Bag	Box
		Min.	Max.	A	B	C	ØD -	ØD +	L	M			
501060	SCF/BB	16	50	45	10	33	17	18	19	7,5	156	-	-