

Connections / Cord end terminals

10904 APF/D

Twin cord end terminal

APF/D cord end terminals are manufactured from electrolytic copper capillary tube with a tin-plated finish to improve electrical contact. The insulating part is made of nylon (PA). They are designed for use in electrical panels.

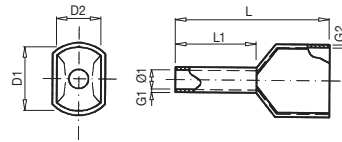

UL certified.

Sec. (mm ²)	L1	Code	Ref.	Colour F	Dimensions (mm)							Kg x1.000	Bag	Box
					Ø1	D2	D1	L	L1	G1	G2			
0.50	8	255100	APF/D-0,50D	WHITE	1.5	2.5	4.7	15.0	8.0	0.15	0.25	0.110	100	3500
0.75	8	258110	APF/D-0,75	BLUE	1.8	2.8	5.0	15.0	8.0	0.15	0.25	0.140	100	3000
1	8	255120	APF/D-1,00D	RED	2.3	3.4	5.4	15.0	8.0	0.15	0.30	0.160	100	2500
1.5	8	255130	APF/D-1,50D	BLACK	2.3	3.6	6.6	16.0	8.0	0.15	0.30	0.200	100	2000
2.5	10	258140	APF/D-2,50	GREY	2.9	4.2	7.8	18.5	10.0	0.20	0.30	0.300	100	1000
4	12	258150	APF/D-4,00	ORANGE	3.8	4.9	8.8	23.0	12.0	0.20	0.30	0.460	100	800
6	14	258160	APF/D-6,00	GREEN	4.9	6.9	10.0	26.0	14.0	0.20	0.40	0.640	100	500
10	14	258170	APF/D-10,00	BROWN	6.5	7.2	13.0	26.0	14.0	0.20	0.40	0.990	100	400
16	14	258180	APF/D-16,00	IVORY	8.3	9.6	18.4	30.0	14.0	0.30	0.40	1.450	100	200

Sec. (mm ²)	L1	Code	Ref.	Colour W	Dimensions (mm)							Kg x1.000	Bag	Box
					Ø1	D2	D1	L	L1	G1	G2			
0.50	8	256100	APF/D-0,50W	ORANGE	1.5	2.5	4.7	15.0	8.0	0.15	0.25	0.110	100	3500
0.75	8	256110	APF/D-0,75W	WHITE	1.8	2.8	5.0	15.0	8.0	0.15	0.25	0.140	100	3000
1	8	256120	APF/D-1,00W	YELLOW	2.3	3.4	5.4	15.0	8.0	0.15	0.30	0.160	100	2500
1.5	8	256130	APF/D-1,50W	RED	2.3	3.6	6.6	16.0	8.0	0.15	0.30	0.200	100	2000
2.5	10	255140	APF/D-2,50D	BLUE	2.9	4.2	7.8	18.5	10.0	0.20	0.30	0.300	100	1000
4	12	255150	APF/D-4,00D	GREY	3.8	4.9	8.8	23.0	12.0	0.20	0.30	0.460	100	800
6	14	256160	APF/D-6,00W	BLACK	4.9	6.9	10.0	26.0	14.0	0.20	0.40	0.640	100	500
10	14	256170	APF/D-10,00W	IVORY	6.5	7.2	13.0	26.0	14.0	0.20	0.40	0.990	100	400
16	14	256180	APF/D-16,00W	GREEN	8.3	9.6	18.4	30.0	14.0	0.30	0.40	1.450	100	200

Connections / Cord end terminals

10904 APF/D

Twin cord end terminal

APF/D cord end terminals are manufactured from electrolytic copper capillary tube with a tin-plated finish to improve electrical contact. The insulating part is made of nylon (PA). They are designed for use in electrical panels.

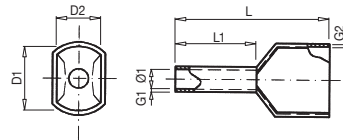

UL certified.

Sec. (mm ²)	L1	Code	Ref.	Colour D	Dimensions (mm)							Kg x1.000	Bag	Box
					ØI	D2	D1	L	L1	G1	G2			
0.50	8	255100	APF/D-0,50D	WHITE	1.5	2.5	4.7	15.0	8.0	0.15	0.25	0.110	100	3500
0.75	8	255110	APF/D-0,75D	GREY	1.8	2.8	5.0	15.0	8.0	0.15	0.25	0.140	100	3000
1	8	255120	APF/D-1,00D	RED	2.3	3.4	5.4	15.0	8.0	0.15	0.30	0.160	100	2500
1.5	8	255130	APF/D-1,50D	BLACK	2.3	3.6	6.6	16.0	8.0	0.15	0.30	0.200	100	2000
2.5	10	255140	APF/D-2,50D	BLUE	2.9	4.2	7.8	18.5	10.0	0.20	0.30	0.300	100	1000
4	12	255150	APF/D-4,00D	GREY	3.8	4.9	8.8	23.0	12.0	0.20	0.30	0.460	100	800
6	14	255160	APF/D-6,00	YELLOW	4.9	6.9	10.0	26.0	14.0	0.20	0.40	0.640	100	500
10	14	255170	APF/D-10,00D	RED	6.5	7.2	13.0	26.0	14.0	0.20	0.40	0.990	100	400
16	14	255180	APF/D-16,00D	BLUE	8.3	9.6	18.4	30.0	14.0	0.30	0.40	1.450	100	200