

# Compression and Mechanical Clamps

CONNECTION CATALOGUE

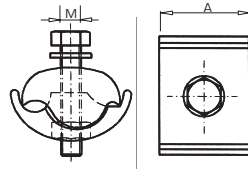
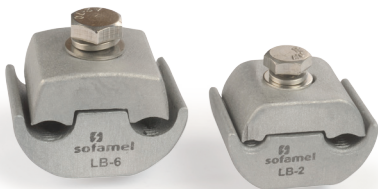

## Mod. LB

Bimetallic mechanical clamp

LB clamps are manufactured from aluminium smelting. Stainless steel screws.

Code	Ref.	Main		Tap		Dimensions (mm)		Kg x 100	Bag	Box
		Max.	Min.	Max.	Min.	A	M			
155100	LB-1	50	6	35	6	29	6	4,060	10	40
155110	LB-2	120	50	35	6	35	8	10,950	10	20
155120	LB-3	185	50	70	10	44	10	18,250	10	10
155130	LB-4	70	25	70	25	32	8	9,400	10	20
155140	LB-5	150	95	95	25	41	10	16,600	5	10
155150	LB-6	150	70	150	70	40	10	16,550	5	10
155160	LB-7	240	95	240	50	50	12	27,300	5	5