

# Insulated Terminals

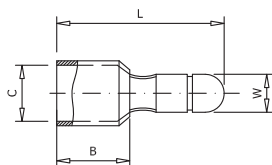



## Connections



### 11003 ACM

#### Insulated male bullet terminal

ACM terminal manufactured from electrolytic copper strap with nylon (PA) insulation. Incorporates an inside fitting which provides a better security to stand possible mechanical vibrations.

Code	Ref.	Section (mm <sup>2</sup> )	Dimensions (mm)				 x 1.000	 Bag	 Box
			W	L	B	C			
305150	ACM-1,5	 1.5	4.0	21.0	10.0	1.7	0.620	100	1600
305160	ACM-2,5	 2.5				2.3	0.680	100	1600