

# sofamel

Product Technical Specifications

## Mod. MCD

DIN 46267 Copper butt connector

### Functionality

Copper cable lug for connections of **LOW** and **MEDIUM VOLTAGE** circuits. They are used in a wide range of sections, both for flexible and rigid copper cables in underground distribution networks. These butt connectors must be crimped by **HEXAGONAL COMPRESSION**.

### Product Features

Manufactured from electrolytic copper with a tinned finish to improve electrical contact.

Incorporates a central stop which facilitates the correct cable positioning.

Beveled ends and a central stop provide easy and correct insertion of the cable.

These copper butt connectors are suitable for indoor and outdoor installations.

The Sofamel cable lugs are marked with the Sofamel logo and the section and the ØT.



### Raw Material Features

#### COPPER

Copper type: **99.9% electrolytic copper**.

Specific gravity: **8.95 gr/cm<sup>3</sup>**.

Conductivity at 20°C: **58.14 Siemens x m/mm<sup>2</sup>**.

Resistivity at 20°C: **0.0172 Ohms x mm<sup>2</sup>/m**.

Surface treatment: **tin bath 5µ thick**.

### Certified

Manufactured according to the standard **DIN 46267**



## Mod. MCD

### DIN 46267 Copper butt connector

#### Dimensions

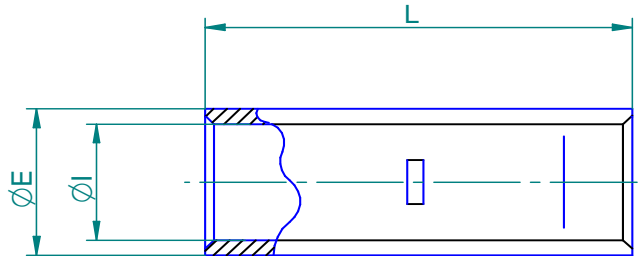

SEC.	REF.	ØE	ØI	L
6	MCD-6	5,5	3,8	30
10	MCD-10	6,0	4,5	30
16	MCD-16	8,5	5,5	50
25	MCD-25	10,0	7,0	50
35	MCD-35	12,5	8,2	50
50	MCD-50	14,5	10,0	56
70	MCD-70	16,5	11,5	56
95	MCD-95	19,0	13,5	70
120	MCD-120	21,0	15,5	70
150	MCD-150	23,5	17,0	80
185	MCD-185	25,5	19,0	85
240	MCD-240	29,0	21,5	90
300	MCD-300	32,0	24,5	100
400	MCD-400	38,5	27,5	150
500	MCD-500	42,0	31,0	160
625	MCD-625	44,0	34,5	160
800	MCD-800	52,0	40,0	200
1000	MCD-1000	58,0	44,0	200