

Shear Head Bolt Connectors

Connections







10201 TTG

Shear head bolt cable lug

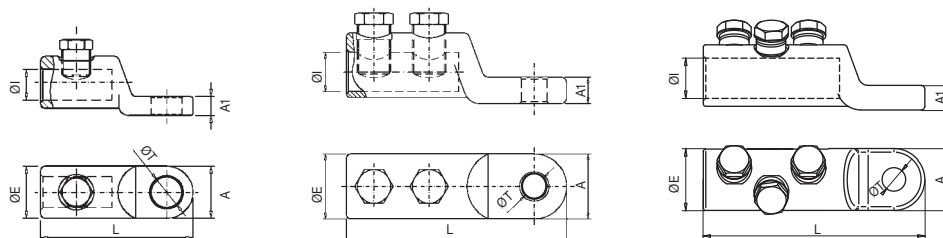
TTG cable lugs are manufactured from high conductivity smelted aluminium of purity higher than 99.5% and with a tin-plated surface finish that covers the complete cable lug surface by means of an electrolytic process.

*According to UNE 211024-3 standard.
Have the  AENOR certified mark.

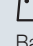
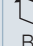

Code	Ref.	Section (mm ²)		Strip length			Dimensions (mm)					Kg x 100			
							ØE	ØI	L	ØT	A				A1
101102	TTG-16/50/8	16 to 50	1	35	1 x M12	12	22	10	64	9	22	8	4.500	1	100
101103	TTG-16/50/10						22	10	64	11	22	8	4.300	1	100
101104	TTG-16/50/12						22	10	64	13	22	8	4.300	1	100
101105	TTG-50/8*	25 to 50	1	35	1 x M12	12	22	10	64	9	22	8	4.500	1	100
101106	TTG-50/10*						22	10	64	11	22	8	4.300	1	100
101107	TTG-50/12*						22	10	64	13	22	8	4.300	1	100
101113	TTG-95/8*	50 to 95	1	35	1 x M12	12	22	13	64	9	22	8	4.400	1	100
101114	TTG-95/10*						22	13	64	11	22	8	4.300	1	100
101115	TTG-95/12*						22	13	64	13	22	8	4.000	1	100
101135	TTG-150/10*	95 to 150	2	60	2 x M17	17	26	16	100	11	26	10	11.000	1	50
101136	TTG-150/12*						26	16	100	13	26	10	10.800	1	50
101099	TTG-240/10*	95 to 240	2	60	2 x M17	17	33	20	112	11	33	13.5	17.300	1	45
101100	TTG-240/12*						33	20	112	13	33	13.5	17.400	1	45
101119	TTG-400/12	240 to 400	2	75	2 x M22	22	40	26	135	13	40	13.5	27.500	1	30
101120	TTG-400/16						40	26	135	17	40	13.5	28.500	1	30
101124	TTG-630/12/T3	500 to 630	3	92	3 x M24	24	52	32.5	165	13	52	20	70.940	1	-
101125	TTG-630/16/T3						52	32.5	165	17	52	20	70.560	1	-
101126	TTG-630/20/T3						52	32.5	165	21	52	20	64.560	1	-
101127	TTG-1000/20/T4	800 to 1000	4	105	4 x M22	22	65	41	175.5	21	65	30	126.400	1	-

