

Bimetallic Connectors

Connections

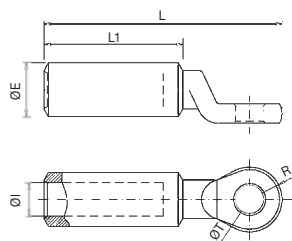

10403 TDC/A

Bimetallic cable lug

TDC/A bimetallic cable lug manufactured from aluminium alloy bar of purity equal or higher than 99.5%. The complete cable lug surface is tinned by means of an electrolytic process.

Incorporates neutral grease to avoid aluminium oxidation. It is especially designed for overhead cable connections.

For overhead cable

Code	Ref.	Section (mm ²)	Dimensions (mm)						Kg x 100	Bag	Box		
			ØE	ØI	ØT	R	L1	L					
111200	TDC/A-30/12	LA-30	20.0	7.6	12.9	13.0	47.1	75.0	5.400	1	125		
111205	TDC/A-54.6/12	LA-54.6		10.0					9.0	-	1	-	
111207	TDC/A-56/8	LA-56			12.0					12.9	4.800	1	125
111210	TDC/A-56/12	LA56									12.5	12.9	4.800
111220	TDC/A-78/12	LA-78			4.520					1			125
111225	TDC/A-80/12	LA-80		4.480	1				125				
111230	TDC/A-110/12	LA-110	25.0	14.5	12.9	15.0	48.0	75.0	9.300	1	80		
111235	TDC/A-145/12	LA-145		16.5					-	1	-		
111240	TDC/A-180/12	LA-180	32.0	18.3	12.9	18.0	70.7	109.0	15.900	1	50		