

# Bimetallic Connectors

## Connections

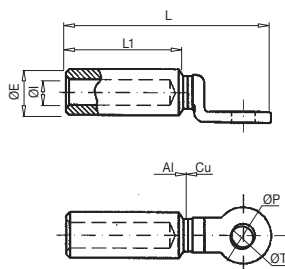

### 10405 TBF

#### Bimetallic cable lug

TBF bimetallic cable lug manufactured from aluminium alloy of purity equal or higher than 99.5%. The palm is manufactured with forged copper. The two parts of the bimetallic cable lug are joined through a friction stir welding process. Incorporates neutral grease to avoid aluminium oxidation.

Comply with the NF C33-090-1 standard.  
Electric and mechanical tests according to CEI 61238-1 standard.

Code	Ref.	Section (mm <sup>2</sup> )	Dimensions (mm)						Kg x 100	Bag	Box
			ØE	ØI	L1	L	ØT	ØP			
110100	TBF-16	16	20.0	5.5	47.5	86.0	12.8	25.0	7.600	1	125
110110	TBF-25	25	20.0	6.5	47.5	86.0	12.8	25.0	7.200	1	125
110120	TBF-35	35	20.0	8.0	47.5	86.0	12.8	25.0	7.200	1	125
110130	TBF-50	50	20.0	9.0	47.5	86.0	12.8	25.0	7.000	1	125
110140	TBF-70	70	20.0	11.0	47.5	86.0	12.8	25.0	7.000	1	125
110150	TBF-95	95	20.0	12.5	47.5	86.0	12.8	25.0	6.300	1	125
110160	TBF-120	120	25.0	13.7	64.0	110.0	12.8	30.0	13.500	1	80
110170	TBF-150	150	25.0	15.5	64.0	110.0	12.8	30.0	12.200	1	80
110180	TBF-185	185	32.0	17.0	64.0	110.0	12.8	30.0	20.100	1	50
110190	TBF-240	240	32.0	19.5	64.0	110.0	12.8	30.0	22.600	1	50
110200	TBF-300	300	40.0	23.3	100.0	154.0	16.5	36.0	33.400	1	32
110210	TBF-400	400	40.0	26.0	100.0	154.0	16.5	36.0	30.200	1	32