

# Conectores de Cobre

## Conexiones

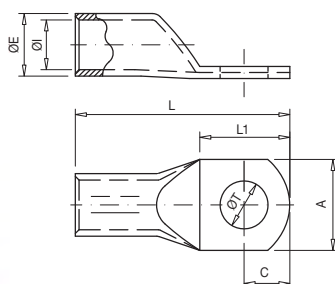

### 10113 TCD

#### Terminal DIN 46235 de cobre reforzado

Los terminales de cobre TCD están fabricados en cobre electrolítico con un acabado superficial estañado para mejorar el contacto eléctrico.

Según DIN 46235.



Código	Ref.	Sección (mm <sup>2</sup> )		Dimensiones (mm)							Kg x 100	Bolsa	Caja
				ØE	ØI	L	ØT	A	L1	C			
005270	TCD-10/6	10	6	6,0	4,5	37,5	6,4	9,0	19,5	9,5	0,350	100	700
005280	TCD-10/8	10	8			40,0	8,4	13,0	21,0	11,0	0,354	100	600
005320	TCD-16/6	16	6	8,5	5,5	46,5	6,4	13,0	18,5	9,5	1,194	50	250
005330	TCD-16/8		8			49,0	8,4	13,0	23,0	11,0	1,206	50	250
005370	TCD-25/8	25	8	10,0	7,0	51,0	8,4	16,0	23,0	12,0	1,551	50	200
005380	TCD-25/10		10			53,0	10,5	17,0	27,0	14,0	1,543	50	200
005420	TCD-35/8	35	8	12,5	8,2	55,0	8,4	17,5	23,0	12,0	3,010	20	120
005430	TCD-35/10		10			57,0	10,5	19,0	27,0	14,0	2,997	20	120
005520	TCD-50/10	50	10	14,5	10	67,0	10,5	22,0	27,0	14,0	4,497	20	100
005530	TCD-50/12		12			68,0	13,0	24,0	29,0	15,0	4,403	20	100
005580	TCD-70/10	70	10	16,5	11,5	70,0	10,5	24,0	27,0	14,0	6,029	20	60
005590	TCD-70/12		12			71,0	13,0	24,0	27,0	14,0	6,065	20	60
005650	TCD-95/12	95	12	19,0	13,5	78,0	13,0	28,0	26,0	13,0	8,373	10	40
005660	TCD-95/14		14			79,5	15,0	32,0	29,0	14,5	8,357	10	40
005670	TCD-95/16		16			81,0	17,0	32,0	32,0	16,0	8,596	10	40
005700	TCD-120/10	120	10	21,0	15,5	85,0	10,5	30,0	27,0	14,0	10,728	10	30
005710	TCD-120/12		12			86,0	13,0	30,0	29,0	15,0	10,436	10	30
005720	TCD-120/14		14			88,0	15,0	30,0	31,0	16,0	10,820	10	30
005730	TCD-120/16		16			89,0	17,0	30,0	35,0	18,0	10,650	10	30
005760	TCD-150/12	150	12	23,5	17,0	94,0	13,0	34,0	29,0	15,0	13,374	10	20
005770	TCD-150/14		14			96,0	15,0	34,0	31,0	16,0	15,514	10	20
005780	TCD-150/16		16			97,0	17,0	34,0	35,0	18,0	15,436	10	20
005810	TCD-185/12	185	12	25,5	19,0	98,0	13,0	37,0	29,0	15,0	18,167	10	20
005820	TCD-185/14		14			100,0	15,0	37,0	31,0	16,0	17,852	10	20
005830	TCD-185/16		16			101,0	17,0	37,0	35,0	18,0	18,227	10	20
005860	TCD-240/12	240	12	29,0	21,5	108,0	13,0	42,0	29,0	15,0	25,766	5	10
005870	TCD-240/14		14			110,0	15,0	42,0	31,0	16,0	25,780	5	10
005880	TCD-240/16		16			111,0	17,0	42,0	35,0	18,0	26,587	5	10
005920	TCD-300/16	300	16	32,0	24,5	119,0	17,0	48,0	35,0	18,0	31,472	5	10
005950	TCD-400/16*	400	16	38,5	27,5	140,0	17,0	55,0	45,0	24,0	53,380	2	4
005980	TCD-500/16*	500	16	42,0	31,0	150,0	17,0	60,0	45,0	24,0	78,187	1	4

\* No cumplen con el certificado UL.