

Conectores de Tornillo Fusible

Conexiones







10201 TTTG

Terminal con tornillo fusible

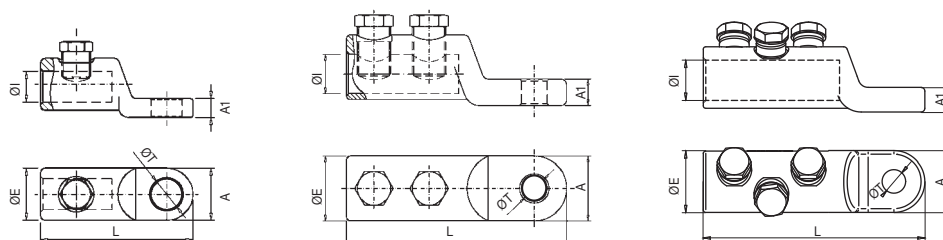
Los terminales TTTG están fabricados por fundición de aluminio de alta conductividad de pureza igual o superior al 99,5% con un acabado superficial estañado que cubre toda la superficie del terminal mediante un baño electrolítico.

Cumplen con la norma UNE 211024-3 y poseen el certificado  de AENOR.*

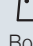
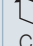

Código	Ref.	Sección (mm ²)	Long. Desforre			Dimensiones (mm)						 x 100	 Bolsa	 Caja	
						ØE	ØI	L	ØT	A	A1				
101102	TTG-16/50/8	16 a 50	1	35	1 x M12	12	22	10	64	9	22	8	4,500	1	100
101103	TTG-16/50/10						22	10	64	11	22	8	4,300	1	100
101104	TTG-16/50/12						22	10	64	13	22	8	4,300	1	100
101105	TTG-50/8*	25 a 50	1	35	1 x M12	12	22	10	64	9	22	8	4,500	1	100
101106	TTG-50/10*						22	10	64	11	22	8	4,300	1	100
101107	TTG-50/12*						22	10	64	13	22	8	4,300	1	100
101113	TTG-95/8*	50 a 95	1	35	1 x M12	12	22	13	64	9	22	8	4,400	1	100
101114	TTG-95/10*						22	13	64	11	22	8	4,300	1	100
101115	TTG-95/12*						22	13	64	13	22	8	4,000	1	100
101135	TTG-150/10*	95 a 150	2	60	2 x M17	17	26	16	100	11	26	10	11,000	1	50
101136	TTG-150/12*						26	16	100	13	26	10	10,800	1	50
101099	TTG-240/10*	95 a 240	2	60	2 x M17	17	33	20	112	11	33	13,5	17,300	1	45
101100	TTG-240/12*						33	20	112	13	33	13,5	17,400	1	45
101119	TTG-400/12	240 a 400	2	75	2 x M22	22	40	26	135	13	40	13,5	27,500	1	30
101120	TTG-400/16						40	26	135	17	40	13,5	28,500	1	30
101124	TTG-630/12/T3	500 a 630	3	92	3 x M24	24	52	32,5	165	13	52	20	70,940	1	-
101125	TTG-630/16/T3						52	32,5	165	17	52	20	70,560	1	-
101126	TTG-630/20/T3						52	32,5	165	21	52	20	64,560	1	-
101127	TTG-1000/20/T4	800 a 1000	4	105	4 x M22	22	65	41	175,5	21	65	30	126,400	1	-

