

## 100 RJA

Reducer aluminium joint

RJA joint manufactured from aluminium alloy of purity equal or higher than 99.5%. Incorporates a central buffer stop which divides the joint in two equal parts. Both holes contain neutral grease to avoid aluminium oxidation.

Code	Ref.	Section Al. (mm <sup>2</sup> )		Dimensions (mm)				Kg x 100	Bag	Box
		1	2	ØE	ØI1	ØI2	L			
100099	RJ1A-50/16		16			5,5		7,570	1	125
100100	RJ1A-50/25	50	25	20	9,0	6,5	106,5	7,450	1	125
100105	RJ1A-50/35		35			8,0		7,240	1	125
110112	RJ1A-70/16		16			5,5		7,180	1	125
100113	RJ1A-70/25	70	25	20	11,0	6,5	106,5	7,060	1	125
100114	RJ1A-70/35		35			8,0		68,50	1	125
100115	RJ1A-70/50		50			9,0		6,680	1	125
100137	RJ1A-95/16		16			5,5		6,840	1	125
100138	RJ1A-95/25		25			6,5		6,720	1	125
100139	RJ1A-95/35	95	35	20	12,5	8,0	106,5	6,510	1	125
100140	RJ1A-95/50		50			9,0		6,340	1	125
100143	RJ1A-95/70		70			11,0		5,950	1	125
10016100	RJ2A-120/16		16			5,5		13,100	1	90
10016101	RJ2A-120/25		25			6,5		12,960	1	90
10016102	RJ2A-120/35	120	35	25	13,7	8,0	133	12,700	1	90
10016103	RJ2A-120/50		50			9,0		12,500	1	90
100145	RJ2A-120/70		70			11,0		12,020	1	90
100146	RJ2A-120/95		95			12,5		11,600	1	90
100147	RJ2A-150/16		16			5,5		12,480	1	90
100148	RJ2A-150/25		25			6,5		12,340	1	90
100149	RJ2A-150/35		35			8,0		12,080	1	90
100150	RJ2A-150/50	150	50	25	15,5	9,0	133	11,880	1	90
100158	RJ2A-150/70		70			11,0		11,400	1	90
100160	RJ2A-150/95		95			12,5		10,900	1	90
100161	RJ2A-150/120		120			13,7		10,610	1	90
10016200	RJ4A-185/16		16			5,5		22,840	1	50
10016201	RJ4A-185/25		25			6,5		22,690	1	50
10016202	RJ4A-185/35		35			8,0		22,410	1	50
10016203	RJ4A-185/50	185	50	32	17,0	9,0	143,5	22,190	1	50
10016204	RJ4A-185/70		70			11,0		21,680	1	50
10016205	RJ4A-185/95		95			12,5		21,240	1	50
10016206	RJ4A-185/120		120			13,7		20,840	1	50
10016207	RJ4A-185/150		150			15,5		20,170	1	50

Other sections under request.

# Aluminium Connectors

CONNECTION CATALOGUE

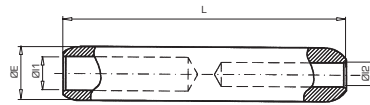

## 100 RJA

Reducer aluminium joint

RJA joint manufactured from aluminium alloy of purity equal or higher than 99.5%. Incorporates a central buffer stop which divides the joint in two equal parts. Both holes contain neutral grease to avoid aluminium oxidation.

Code	Ref.	Section Al. (mm <sup>2</sup> )		Dimensions (mm)				Kg x 100	Bag	Box
		1	2	ØE	ØI1	ØI2	L			
10016208	RJ4A-240/16		16			5,5		21,680	1	50
100163	RJ4A-240/25		25			6,5		21,530	1	50
100164	RJ4A-240/35		35			8,0		21,250	1	50
100165	RJ4A-240/50		50			9,0		21,030	1	50
100168	RJ4A-240/70	250	70	32	19,5	11,0	143,5	20,520	1	50
100170	RJ4A-240/95		95			12,5		20,080	1	50
100175	RJ4A-240/120		120			13,7		19,680	1	50
100180	RJ4A-240/150		150			15,5		19,010	1	50
100181	RJ4A-240/185		185			17,0		18,390	1	50
100182	RJ5A-300/16		16			5,5		53,750	1	15
100183	RJ5A-300/25		25			6,5		53,510	1	15
100184	RJ5A-300/35		35			8,0		53,070	1	15
100185	RJ5A-300/50		50			9,0		52,350	1	15
100186	RJ5A-300/70	300	70	40	23,3	11,0	218	51,920	1	15
100187	RJ5A-300/95		95			12,5		51,210	1	15
100188	RJ5A-300/120		120			13,7		50,580	1	15
100189	RJ5A-300/150		150			15,5		49,520	1	15
100190	RJ5A-300/185		185			17,0		48,540	1	15
100191	RJ5A-300/240		240			19,5		46,700	1	15
100193	RJ5A-400/16		16			5,5		51,070	1	15
100194	RJ5A-400/25		25			6,5		50,830	1	15
100195	RJ5A-400/35		35			8,0		50,390	1	15
100196	RJ5A-400/50		50			9,0		49,670	1	15
100197	RJ5A-400/70	400	70	40	26,0	11,0	218	49,240	1	15
100198	RJ5A-400/95		95			12,5		48,530	1	15
100199	RJ5A-400/120		120			13,7		47,900	1	15
100200	RJ5A-400/150		150			15,5		46,840	1	15
100205	RJ5A-400/185		185			17,0		45,860	1	15
100210	RJ5A-400/240		240			19,5		44,020	1	15
100215	RJ5A-400/300		300			23,3		40,750	1	15

Other sections under request.