

# sofamel

Product Technical Specifications

## Mod. AFH

Insulated female connector

### Functionality

These pre-insulated copper terminals are used where a plug-in female connection is required. They consist of an insulated tubular input for wiring and a plug-in connector.

### Product Features

AFH pre-insulated terminals are made of electrolytic copper strapping and PVC insulation. They incorporate an inner bushing that provides greater safety to withstand possible mechanical vibrations.

Heat resistance is -10 to 75°C.

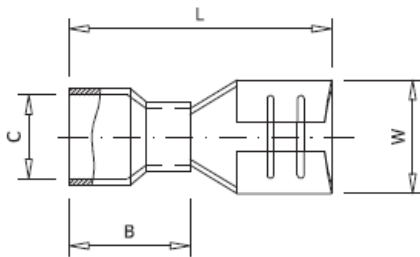

### Dimensions

AFH-1,5/2,8	1,5	3,2	19,0	10,5	1,7
AFH-1,5/4,8		5,0	19,4		
AFH-1,5/6,3		6,6	20,8		
AFH-2,5/4,8	2,5	5,0	19,4	10,5	2,3
AFH-2,5/6,3		6,6	20,8		
AFH-6/6,3	6,0	6,6	23,3	13,0	3,4
AFH-6/9,5		10,0	28,6		
REFERENCIA	SECCION mm <sup>2</sup>	W	L	B	C



## Mod. AFH

### Insulated female connector

---

#### Raw material Characteristics

Conductor: **H62 / C28000 brass strip**

Copper sleeve: **T2 / C11000 copper tubular**

Insulation: **PVC**

Finish: **Tinned**

#### Electrical characteristics

The maximum intensity depends on the section of the cable used,  
if it is ventilated it will hold more current.

With the AFH terminal:

Section 1.5 mm<sup>2</sup> and cable of 1.5 mm<sup>2</sup> can hold between 13 and 15,5A.

Section 2.5 mm<sup>2</sup> and cable 2.5 mm<sup>2</sup> can hold between 18 and 21A.

Section 6 mm<sup>2</sup> and cable 6 mm<sup>2</sup> can hold between 31 and 36A.

#### Certified

And according to the **UNE 21021** standard: Connection parts for power lines up to 72.5 kV.

They comply with European Union Directive **2015/863 / EU (RoHS 3)**.