

# sofamel

Product Technical Specifications

## Mod. MBI

Medium voltage bimetallic joint



### Functionality

MBI bimetallic sleeves are made of 99.5% or higher aluminium alloy and electrolytic copper tube. By means of a friction welding process, the two materials are joined together form the bimetallic sleeve. It has built-in neutral grease in the hole of the aluminum part to prevent oxidation of the same. Designed for low voltage connections.

### Raw Material Features

#### ALUMINIUM

High purity aluminium (99.5% or higher).

#### Copper

Electrolytic copper

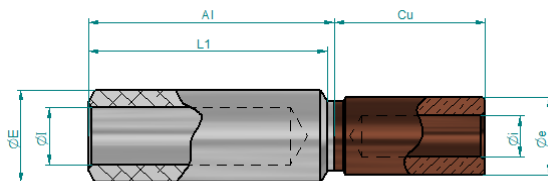

### Certificates

Measurements according to C33-090-1



## Mod. MBI

### Medium voltage bimetallic joint

#### Dimensions

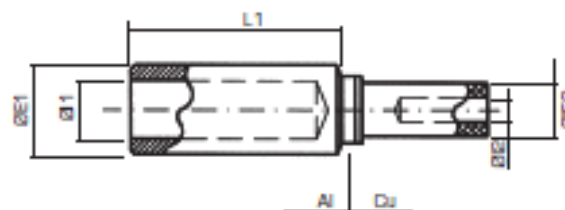

| Código | Ref.        | Sección (mm <sup>2</sup> ) |     | Dimensiones (mm) |      |      |      |      | Kg<br>x 100 | Bolsa | Caja |
|--------|-------------|----------------------------|-----|------------------|------|------|------|------|-------------|-------|------|
|        |             | Al                         | Cu  | ØE1              | ØI1  | L1   | ØE2  | ØI2  |             |       |      |
| 130097 | MBI-50/16   |                            | 16  |                  |      | 48,0 | 12,2 | 5,5  | 6,020       | 1     | 25   |
| 130100 | MBI-50/25   | 50                         | 25  | 20,0             | 9,0  | 48,0 | 12,2 | 7,0  | 6,500       | 1     | 25   |
| 130101 | MBI-50/35   |                            | 35  |                  |      | 48,0 | 12,2 | 8,0  | 5,210       | 1     | 25   |
| 130107 | MBI-95/16   |                            | 16  |                  |      | 48,0 | 12,2 | 5,5  | 6,200       | 1     | 25   |
| 130108 | MBI-95/25   |                            | 25  |                  |      | 48,0 | 12,2 | 7,0  | 5,800       | 1     | 25   |
| 130109 | MBI-95/35   | 95                         | 35  | 20,0             | 12,5 | 48,0 | 12,2 | 8,0  | 4,440       | 1     | 25   |
| 130110 | MBI-95/50   |                            | 50  |                  |      | 48,0 | 12,2 | 9,5  | 5,000       | 1     | 25   |
| 130111 | MBI-95/70   |                            | 70  |                  |      | 48,0 | 21,0 | 11,0 | 11,900      | 1     | 25   |
| 130117 | MBI-150/16  |                            | 16  |                  |      | 65,0 | 12,2 | 5,5  | 8,070       | 1     | 20   |
| 130118 | MBI-150/25  |                            | 25  |                  |      | 65,0 | 12,2 | 7,0  | 7,760       | 1     | 20   |
| 130119 | MBI-150/35  |                            | 35  |                  |      | 65,0 | 12,2 | 8,0  | 7,260       | 1     | 20   |
| 130120 | MBI-150/50  | 150                        | 50  | 25,0             | 15,5 | 65,0 | 12,2 | 9,5  | 8,500       | 1     | 20   |
| 130125 | MBI-150/70  |                            | 70  |                  |      | 65,0 | 21,0 | 11,0 | 13,910      | 1     | 20   |
| 130130 | MBI-150/95  |                            | 95  |                  |      | 65,0 | 21,0 | 13,0 | 14,300      | 1     | 20   |
| 130132 | MBI-150/120 |                            | 120 |                  |      | 65,0 | 21,0 | 14,2 | 11,740      | 1     | 20   |
| 130142 | MBI-240/16  |                            | 16  |                  |      | 65,0 | 12,2 | 5,5  | 11,640      | 1     | 10   |
| 130133 | MBI-240/25  |                            | 25  |                  |      | 65,0 | 12,2 | 7,0  | 13,300      | 1     | 10   |
| 130134 | MBI-240/35  |                            | 35  |                  |      | 65,0 | 12,2 | 8,0  | 10,830      | 1     | 10   |
| 130135 | MBI-240/50  |                            | 50  |                  |      | 65,0 | 12,2 | 9,5  | 12,900      | 1     | 10   |
| 130136 | MBI-240/70  | 240                        | 70  | 32,0             | 19,5 | 65,0 | 12,2 | 11,0 | 17,480      | 1     | 10   |
| 130137 | MBI-240/95  |                            | 95  |                  |      | 65,0 | 21,0 | 13,0 | 18,000      | 1     | 10   |
| 130138 | MBI-240/120 |                            | 120 |                  |      | 65,0 | 21,0 | 14,2 | 15,310      | 1     | 10   |
| 130140 | MBI-240/150 |                            | 150 |                  |      | 65,0 | 21,0 | 16,0 | 16,500      | 1     | 10   |
| 130141 | MBI-240/185 |                            | 185 |                  |      | 65,0 | 26,0 | 18,0 | 21,170      | 1     | 10   |

Otras secciones bajo pedido.

Datos sujetos a cambios  
2020, Mayo 14

© 2017 Sofamel SLU  
Todos los derechos reservados.

Versión: R2-7.2 COM01

Las especificaciones están sujetas a cambios sin previo aviso.