

# Terminali Preisolati

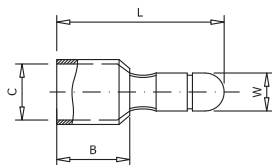



## Connessioni



### 11003 ACM

#### Capicorda innesto cilindrico preisolato

I capicorda con innesto cilindrico serie ACM sono in rame elettrolitico con isolamento in PVC. Dispongono anche di un connettore interno che garantisce maggiore resistenza ad eventuali vibrazioni meccaniche.

Codice	Rif.	Sezione (mm <sup>2</sup> )	Dimensioni (mm)				 x 1.000	 Borsa	 Scatola
			W	L	B	C			
305150	ACM-1,5	 1,5	4,0	21,0	10,0	1,7	0,620	100	1600
305160	ACM-2,5	 2,5				2,3	0,680	100	1600