

Capicorda in Rame

Connessioni

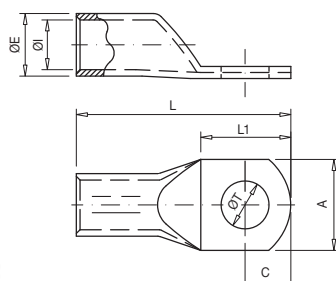

10113 TCD

Capicorda in rame rinforzato DIN 46235

I terminali in rame TCD sono realizzati in rame elettrolitico con una finitura superficiale stagnata che protegge dall'ossidazione.

Il loro design rinforzato li rende particolarmente adatti per installazioni soggette a vibrazioni o elevati sforzi meccanici.

Conforme alla norma DIN 46235.



Codice	Rif.	Sezione (mm ²)		Dimensioni (mm)							Kg x 100	Borsa	Scatola
				ØE	ØI	L	ØT	A	L1	C			
005270	TCD-10/6	10	6	6,0	4,5	37,5	6,4	9,0	19,5	9,5	0,350	100	700
005280	TCD-10/8		8			40,0	8,4	13,0	21,0	11,0	0,354	100	600
005320	TCD-16/6	16	6	8,5	5,5	46,5	6,4	13,0	18,5	9,5	1,194	50	250
005330	TCD-16/8		8			49,0	8,4	13,0	23,0	11,0	1,206	50	250
005370	TCD-25/8	25	8	10,0	7,0	51,0	8,4	16,0	23,0	12,0	1,551	50	200
005380	TCD-25/10		10			53,0	10,5	17,0	27,0	14,0	1,543	50	200
005420	TCD-35/8	35	8	12,5	8,2	55,0	8,4	17,5	23,0	12,0	3,010	20	120
005430	TCD-35/10		10			57,0	10,5	19,0	27,0	14,0	2,997	20	120
005520	TCD-50/10	50	10	14,5	10	67,0	10,5	22,0	27,0	14,0	4,497	20	100
005530	TCD-50/12		12			68,0	13,0	24,0	29,0	15,0	4,403	20	100
005580	TCD-70/10	70	10	16,5	11,5	70,0	10,5	24,0	27,0	14,0	6,029	20	60
005590	TCD-70/12		12			71,0	13,0	24,0	27,0	14,0	6,065	20	60
005650	TCD-95/12	95	12	19,0	13,5	78,0	13,0	28,0	26,0	13,0	8,373	10	40
005660	TCD-95/14		14			79,5	15,0	32,0	29,0	14,5	8,357	10	40
005670	TCD-95/16		16			81,0	17,0	32,0	32,0	16,0	8,596	10	40
005700	TCD-120/10	120	10	21,0	15,5	85,0	10,5	30,0	27,0	14,0	10,728	10	30
005710	TCD-120/12		12			86,0	13,0	30,0	29,0	15,0	10,436	10	30
005720	TCD-120/14		14			88,0	15,0	30,0	31,0	16,0	10,820	10	30
005730	TCD-120/16		16			89,0	17,0	30,0	35,0	18,0	10,650	10	30
005760	TCD-150/12	150	12	23,5	17,0	94,0	13,0	34,0	29,0	15,0	13,374	10	20
005770	TCD-150/14		14			96,0	15,0	34,0	31,0	16,0	15,514	10	20
005780	TCD-150/16		16			97,0	17,0	34,0	35,0	18,0	15,436	10	20
005810	TCD-185/12	185	12	25,5	19,0	98,0	13,0	37,0	29,0	15,0	18,167	10	20
005820	TCD-185/14		14			100,0	15,0	37,0	31,0	16,0	17,852	10	20
005830	TCD-185/16		16			101,0	17,0	37,0	35,0	18,0	18,227	10	20
005860	TCD-240/12	240	12	29,0	21,5	108,0	13,0	42,0	29,0	15,0	25,766	5	10
005870	TCD-240/14		14			110,0	15,0	42,0	31,0	16,0	25,780	5	10
005880	TCD-240/16		16			111,0	17,0	42,0	35,0	18,0	26,587	5	10
005920	TCD-300/16	300	16	32,0	24,5	119,0	17,0	48,0	35,0	18,0	31,472	5	10
005950	TCD-400/16*	400	16	38,5	27,5	140,0	17,0	55,0	45,0	24,0	53,380	2	4
005980	TCD-500/16*	500	16	42,0	31,0	150,0	17,0	60,0	45,0	24,0	78,187	1	4

* Non sono conformi alla certificazione UL.